

Conferences at Hotel Eden Spiez 2016



LIKE IN PARADISE - CONFERENCES ON LAKE THUN

Whether for an intimate meeting or an event for up to 165 persons: the climate-controlled seminar facilities are a cut above thanks to the tasteful decor - using only the finest materials - and the latest, user-friendly technologies. Each room boasts a panoramic view of Lake Thun and the Bernese Alps with the famous Eiger, Mönch and Jungfrau peaks.

The ten bright rooms with panorama windows can be combined and - along with the foyer and terrace - create an intimate experience for meetings, seminars, workshops, off-site get togethers, banquets or cocktail parties. Moreover, the superb location, charming park, panoramic terraces and exceptional hotel facilities will add to the success of your business meeting or private event. If you are looking for memorable moments and incentives we are happy to provide suggestions for a wide range of exceptional activities in the region.

If you would like to have a look at our new facilities, please feel free to contact us and we will be happy to give you a tour.

Meeting & Event
Telefon +41 (0) 33 655 97 00
meeting@eden-spiez.ch

FLOOR PLAN – INFRASTRUCTURE MADE TO MEASURE

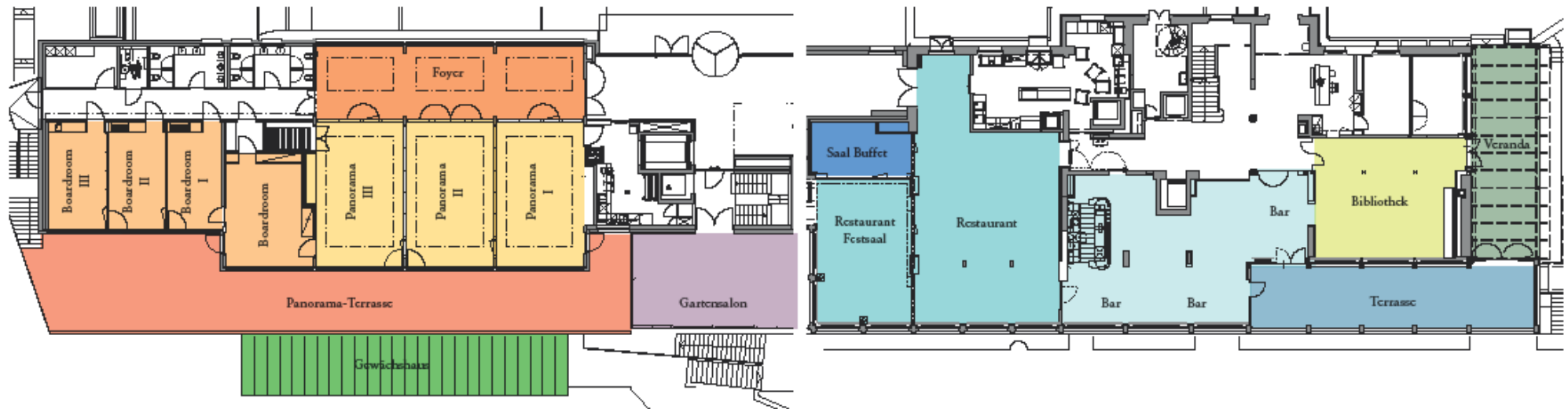

Name	m ²	Höhe	Parlamentarisch	Bankett	U-Form	Konzert	Cocktail
Einzel							
Panorama I	45.5	3.5/3.8	20	35	16	35	18
Panorama II	45.5	3.5/3.8	20	35	16	35	18
Panorama III	45.5	3.5/3.8	20	35	16	35	18
Boardroom	33.0	3.0	(10)	(12)	8	(25)	
Boardroom I	20.0	3.0	(8)	(12)	8	(15)	
Boardroom II	20.0	3.0	(8)	(12)	8	(15)	
Boardroom III	23.2	3.0	(8)	(12)	8	(15)	
Foyer	69.0	3.2					55
Panorama-Terrasse	170.0				(64)	150	
Garten-Salon	61.0					18	50

Name	m ²	Höhe	Parlamentarisch	Bankett	U-Form	Konzert	Cocktail
Variablen							
Panorama I+II	91.0	3.5/3.8	36	60	40	70	27
Panorama I-III	136.5	3.5/3.8	63	100	80	110	39
Panorama II-III	91.0	3.5/3.8	36	60	40	70	27
Panorama I-III + Foyer	205.5	3.5/3.8		150	120	165	
Boardroom I+II	40.0	3.0					
Boardroom II+III	43.2	3.0			12	(35)	
Boardroom I-III	63.2	3.0	(16)	(42)	22	(55)	

Name	m ²	Höhe	Parlamentarisch	Bankett	U-Form	Konzert	Cocktail
Hotel							
Bibliothek	62.0	3.25					45
Bar	88.0	3.25					60
Restaurant	114.0	3.25			30	100	
Restaurant-Festsaal	51.0	3.25	22	35	18	40	
Restaurant & Festsaal	165.0	3.25			72	140	
Saal Buffet	18.0	3.25					
Veranda	53.0						40
Terrasse	86.0						70

Name	m ²	Höhe	Parlamentarisch	Bankett	U-Form	Konzert	Cocktail
Umgebung							
Gewächshaus	22	2.9					20
Park	2500						500
Tennisplatz	590					180	350
Rosenvilla	10	2.15					
Bödeli	29	2.20					25
Jass-Hüsti	10	2.15					15
Vinothek	30						25

DAILY DELEGATE PACKAGES

	Halbtagespauschale ohne Mittagessen*	Halbtagespauschale mit Mittagessen*	Tagespauschale Eden	Seminarpauschale
Room rental	√	√	√	√
Projector&screen	√	√	√	√
1 Flip chart	√	√	√	√
1 Pinboard	√	√	√	√
1 Moderator cart	√	√	√	√
W-LAN	√	√	√	√
Writing set for each participant	√	√	√	√
1 Coffee break	√	√		
2 coffee breaks			√	√
2 Mineral water in the room	√	√	√	√
3-course business lunch, cocktail-buffet or stand-up buffet (from 20 persons)		√	√	√
1 overnight in a stylish room				√
Underground parking	√	√	√	√
Softdrinks in the room	CHF 5.00 additional charge per Person	CHF 5.00 additional charge per Person	CHF 5.00 additional charge per Person	CHF 5.00 additional charge per Person
A market fresch 3-course menu	CHF 55.00 additional charge per Person	CHF 55.00 additional charge per Person	CHF 55.00 additional charge per Person	CHF 55.00 additional charge per Person
A market fresch 4-course menu	CHF 65.00 additional charge per Person	CHF 65.00 additional charge per Person	CHF 65.00 additional charge per Person	CHF 65.00 additional charge per Person
Prices per person in CHF (from 10 persons)	51.00	86.00	105.00	Starting at 330.00

* possible from 07.00-12.30h or 14.00-19.30h

For groups of less than 10 persons we have to charge a set-up fee. We will be happy to provide you with a tailor-made offer. Please contact us by telephone or e-mail, a contact form is available on our homepage.

CONFERENCES À LA CARTE

Would you like to plan your own conference? Please choose from one of the following offers:

- Welcome coffee & croissants
with coffee, tea, juices and croissants CHF 10.50
- Coffee break
With coffee, tea, juices, pastries and a
variety of tasty treats prepared by our chef CHF 14.50
- 3-course business-lunch for spouses or partner CHF 35.00
- Beverage package
incl. water, apple juice and coffee or tea CHF 9.50
- A market fresh 3- Course Dinner p.P CHF 55.00
A market fresh 4- Course Dinner p.P. CHF 65.00
- Refrigerator with Softdrinks p.P. CHF 5.00
Coca Cola, Coca Cola Zero, Rivella red

All prices mentioned above are per person.



TECHNICAL INFRASTRUCTURE TO CHOOSE FROM

Technical facilities

See the list below for all available equipment and prices. Any additional equipment can be hired upon request from our partners.

Rental prices for additional equipment:

• PowerPoint projector	CHF 150.00
• Flip chart including 10 sheets (1x in packages included)	CHF 25.00
• Pinboard & magnetic whiteboard (1x in packages included)	CHF 20.00
• Moderator's cart (1x in packages included)	CHF 30.00
• DVD player	CHF 50.00
• Bluetooth clip-on microphone	CHF 75.00
• Bluetooth handheld microphone	CHF 75.00
• External speakers	CHF 100.00
• Bluetooth mouse/wireless presenter	CHF 25.00
• LCD monitor	CHF 100.00
• Video recorder	CHF 50.00
• Illuminator documentation	CHF 35.00
• Digital video camera	CHF 100.00
• Laptop (available upon request)	CHF 75.00
• Speaker's desk (incl. 1 microphone, house installation)	CHF 150.00
• Piano (without extra tuning)	CHF 300.00
• Stage	upon request
• Conference call system	upon request
• Video conference system	upon request

Office and printed matter:

• Printed menus	per card CHF 3.00
On our menu stationary with the Eden logo	
• In-room giveaway distribution	per guest CHF 3.50
We are happy to distribute your business cards, gifts, schedules or any other items to the rooms of your participants.	
• Copies & prints	
black & white	per page & side CHF 0.40
color	per page & side CHF 0.80
• Underground parking	CHF 10.00
• Welcome –Desk or reception	upon request
• Typing	upon request

All above prices are per item per day

GOOD TO KNOW

Every event is unique. The Eden team will be pleased to put together an authentic itinerary just for you and take care of all the details. Just provide us with the additional information we'll need to meet your demands.

Details

The sooner we know your special requests, the better we'll be able to implement them. Please let us know the following details at least 14 days prior to your event:

- Arrival time and detailed programme
- Number of guests (including special requests for vegetarians, people with food allergies)
- Seating requests
- Technical infrastructure
- Choice of pre-dinner cocktail, menu and wine selection
- Full name of all guests staying overnight
- Room labelling
- Billing with billing address

Food and Drinks

Please note that we do not recommend à la carte service for more than 9 persons. Our daily seasonal 3- and 4-course menus are available. Guests can choose a meat, fish or vegetarian main course. With advance notice, our head chef and his team will gladly make arrangements to meet your special food requests. The Eden team is happy to help you select the menu best suited to your event.

Out of consideration for our neighbours, we kindly ask that you refrain from gathering outside after 10pm.

Parking

The hotel Eden has paid underground parking with 58 spaces. Depending on availability we can provide parking for your participants. Should there not be enough parking available, you can find paid public parking 300m from the hotel.

Loss and Damage

The client is reliable for any loss or damage of fixtures and/or inventory caused by his employees and/or participants.

GOOD TO KNOW

Guarantee

An Eden technician is on hand to help in case of any technical problems you may experience. However, this is not considered grounds for a price reduction. If the problem cannot be fixed, the price will be reduced by the rental cost of the technical equipment only. Further claims cannot be accepted.

Annulation fees

In case of cancellation the following fees will be charged:

For groups up to 20 rooms (according to the booking confirmation):

- up to 60 days upon arrival: free of charge
- 59 – 30 days upon arrival: 50 % of the lost volume of room sales
- 29 – 8 days upon arrival: 80 % of the lost volume of room sales
- up to 7 days upon arrival: 100 % of the lost volume of room sales

For groups with 21 - 43 rooms (according to the booking confirmation):

- up to 90 days upon arrival: free of charge
- 89 – 60 days upon arrival: 40 % of the lost volume of room sales
- 59 – 30 days upon arrival: 60 % of the lost volume of room sales
- 29 – 8 days upon arrival: 80 % of the lost volume of room sales
- up to 7 days upon arrival: 100 % of the lost volume of room sales

For booking of meeting & event location (according to the booking confirmation):

- up to 90 days upon the start of the event: free of charge
- 89 - 60 days upon the start of the event: 40 % of the estimate sales
- 59 - 30 days upon the start of the event: 60 % of the estimate sales
- 29 - 8 days upon start of the event: 80 % of the estimate sales
- up to 7 days upon start of the event: 100 % of the estimate sales



The price includes service and VAT. Last update February 2016. Subject to change without further notice.